

Metos Marine refrigerators and freezers are designed primarily for the demanding conditions of marine kitchens. The design of the cabinets makes them suitable even for limited spaces. Many details, such as adjustable legs and reinforced door hinges are dimensioned for the demanding marine environment.

The cabinets have an electronic control system to regulate and monitor the temperature and defrosting. The built-in evaporation of condensate water is automatic. Includes a control panel with a digital display. Cabinets have lockable doors and interior lighting. The construction is designed for easy cleaning.

All insulation materials and coolants are environmental friendly, insulation is done with foamed polyurethane. The refrigerant in MBC models is R134a, in MBF models R404A. Temperature range in the refrigerator is +1...+10°C and in the freezer -18...-23°C. In addition to the standard models it is possible to tailor the refrigeration units to suit the electrical system used by the customer.

● **Refrigerators optionally available with glass door**



Refrigerator	Outer dimensions W x D x H mm	Net volume liters	Shelves mm	Weight net/ gross kg	Noise level dB	Heat output in full power kW	230V1~ 50/60Hz	115V1~ 60Hz
MBC-200	610 x 667 x 1280	169	1x 450x450	61/65	45	0.439	0.222	0.222
MBC-300	610 x 667 x 1640	260	3x 450x450	82/88	45	0.534	0.240	0.240
MBC-400	610 x 747 x 1980	389	4x 450x500	104/110	49	0.710	0.334	0.334
MBC-500	710 x 747 x 1980	436	4x 550x500	108/114	49	0.631	0.255	0.255
MBC-600	810 x 747 x 1980	547	4x 650x500	119/126	49	0.683	0.287	0.287
MBC-700	810 x 747 x 2140	615	4x 650x500	136/143	49	0.683	0.287	0.287
MBC-1000	1230 x 747 x 2140	870	8x 450x500	215/221	57	1.636	0.730	0.730
MBC-1400	1630 x 747 x 2140	1220	8x 650x500	246/252	57	1.636	0.730	0.730
Freezer								
MBF-200	610 x 667 x 1280	169	1x 450x450	63/67	57	0.490	0.274	0.274
MBF-300	610 x 667 x 1640	260	3x 450x450	87/93	61	0.661	0.341	0.341
MBF-400	610 x 747 x 1980	389	4x 450x500	115/121	61	0.661	0.341	0.341
MBF-500	710 x 747 x 1980	436	4x 550x500	118/124	61	0.661	0.341	0.341
MBF-600	810 x 747 x 1980	547	4x 650x500	125/131	61	0.818	0.418	0.418
MBF-700	810 x 747 x 2140	615	4x 650x500	141/148	61	0.818	0.418	0.418
MBF-1000	1230 x 747 x 2140	870	8x 450x500	265/271	61	1.802	1.260	1.260
MBF-1400	1630 x 747 x 2140	1220	8x 650x500	285/291	61	2.025	1.495	1.495
Refrigerator/ Freezer								
MBC/MBF-500	710 x 747 x 1980	2x 196	4x 550x500	135/141	57	1.100	0.222/0.274	0.222/0.274
MBC/MBF-700	810 x 747 x 2140	2x 311	4x 650x500	155/161	61	1.371	0.334/0.341	0.334/0.341

MBC: Refrigerant R134 A. Temperature range +1...+10°C. Insulation foamed polyurethan.
MBF: Refrigerant R404 A. Temperature range -18...-23°C. Insulation foamed polyurethan.

- Specially designed for demanding marine use
- Wide model range
- Easy to use and service
- Environmental friendly coolant and insulation
- Hygienic stainless steel construction
- Fans distribute cold air evenly (refrigerator)
- Control panel with digital display
- Lockable doors and interior light
- Electronic control of temperature and defrosting
- IP class 44

Door gasket is easy to change.

Our Marine series of refrigerators and freezers is of sturdy stainless steel throughout. The adjustable legs are equipped for floor attachment.

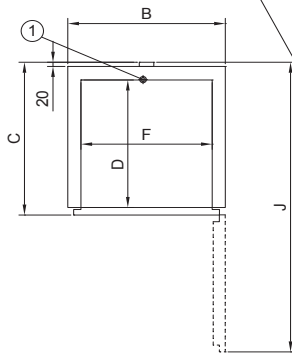
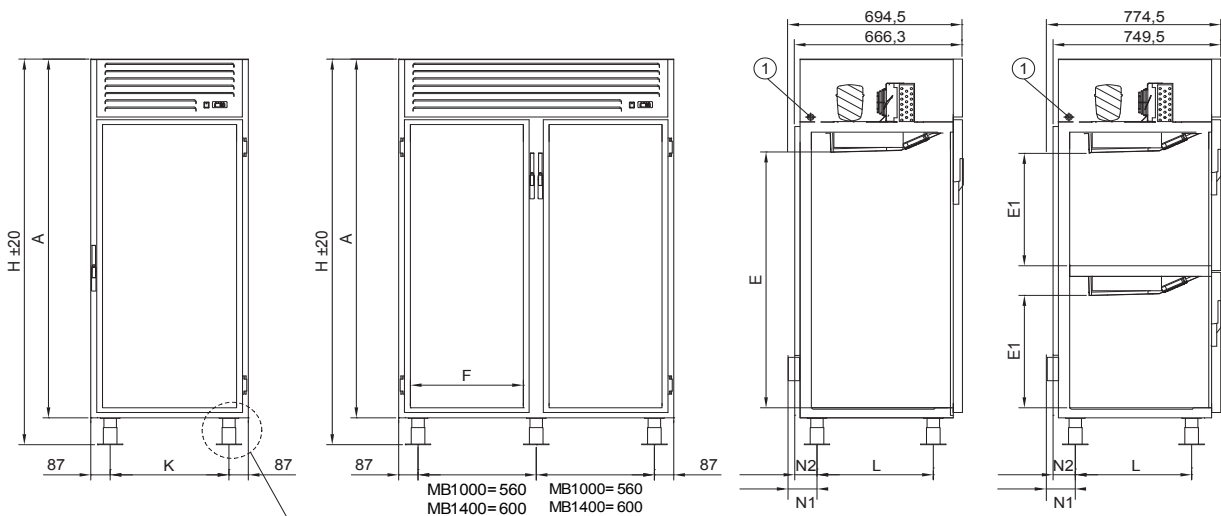

Metos	A	B	C	D	E	E1	F	H	J	K	L	N1	N2
MB 200	1100	610	693	530	610	-	490	1260	1260	480	470	114,5	76
MB 300	1460	610	693	530	960	-	490	1620	1260	480	470	114,5	76
MB 400	1800	610	773	610	1260	-	490	1960	1340	480	540	101	76
MB 500	1800	710	773	610	1260	-	590	1960	1440	580	540	101	76
MB 600	1800	810	773	610	1260	-	690	1960	1530	680	540	101	76
MB 700	1960	810	773	610	1420	-	690	2120	1530	680	540	101	76
MB 1000	1960	1230	773	610	1420	-	490	2120	1530	-	520	117	93
MB 1400	1960	1630	773	610	1420	-	690	2120	1530	-	520	117	93
MBC/MBF 500	1800	710	773	610	-	530	690	1960	1530	580	540	101	76
MBC/MBF 700	1960	810	773	610	-	670	690	2120	1530	680	540	101	76

∅ 8.5 FOR SCREW M8

